

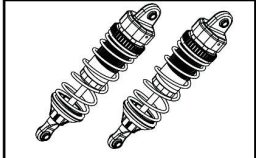

HI903-001 Tyre unit
(white) 2pcs
HI903-002 Tyre unit
(chromed) 2pcs

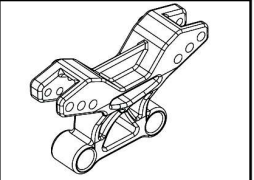

HI903-003 Shock absorber
unit(plastic) 2pcs



HI903-005 Shock tower

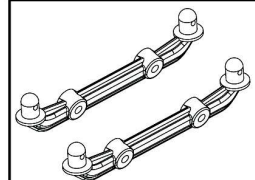

HI903-006 Fr/Rr body
mount

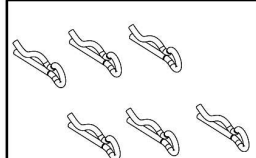

HI903-007 Body pin 1.5
6pcs



HI903-008 Upper susp. Arm
2set

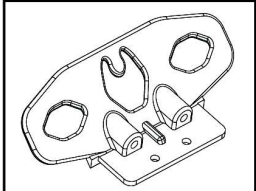

HI903-009 Fr. bumper 1pc

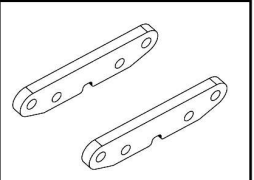

HI903-010 Suspension
arm mount 2pcs

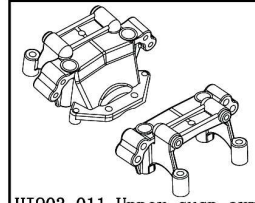

HI903-011 Upper susp. arm
mount-Fr/Rr

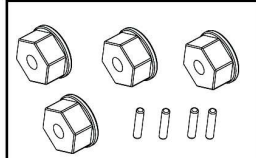

HI903-012 Rim hub w/pin
2*10 4pcs

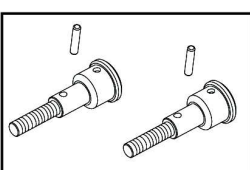

HI903-013 Axle w/pin
2pcs

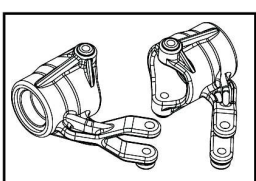

HI903-015 Kunckle arm

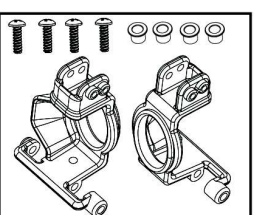

HI903-017 C-Hub
w/screw

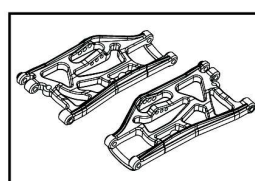

HI903-018 Fr. lower susp.
arm-Fr/Rr

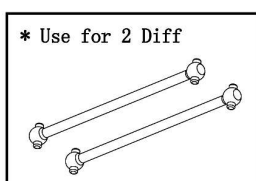

* Use for 2 Diff

HI903-019 Transverse
driver shaft set 2pcs
φ 4*87.5mm

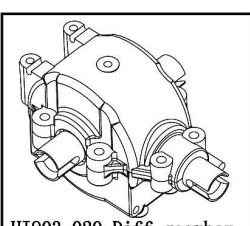

HI903-020 Diff. gearbox
unit

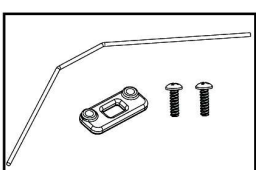

HI903-021 Anti-roll bar
set

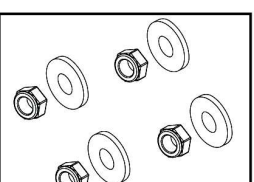

HI903-022 M4 Self lock
-nut
w/washer 4pcs

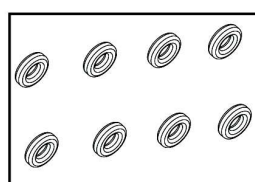

HI903-023 O-washer 8pcs

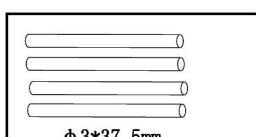

HI903-024 Front suspens-
ion arm pin-short 4pcs
φ 3*37.5mm

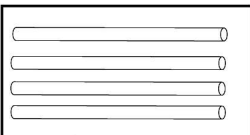

φ 3*56mm

HI903-025 Suspension
arm pin-long 4pcs

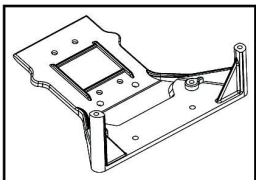

HI903-026 Damper

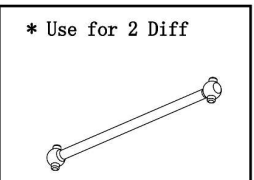

* Use for 2 Diff

HI903-027 Centre drive
shaft-Fr φ 3.5*88.8mm

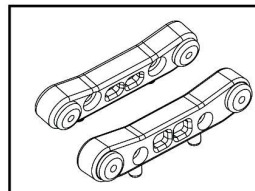

HI903-028 Lower susp.
mount block-Fr/Rr

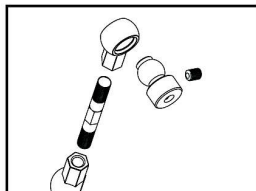

HI903-029 Anti-roll bar
fixation set

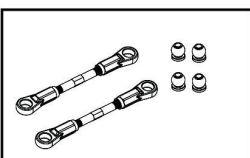

HI903-030 Steeringlink-
-age set 2set

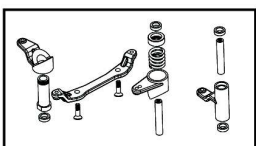

HI903-031 Servo saver
unit

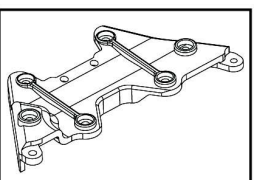

HI903-032 Upper deck-Fr

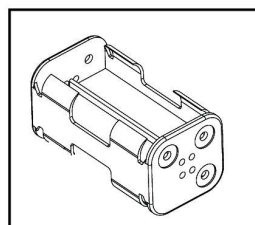

HI903-033 Battery case

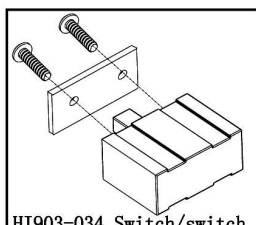

HI903-034 Switch/switch
cover/screw

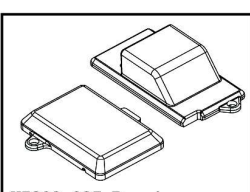

HI903-035 Receiver case
cover
Battery case cover

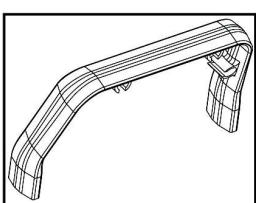

HI903-036 Rear aluminum
shocks

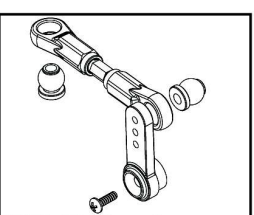

HI903-037 Steering servo
horn and linkage 1set

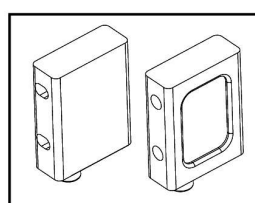

HI903-038 Streering
servo mount-A/B

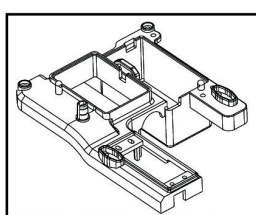

HI903-039 Upper deck
-centre

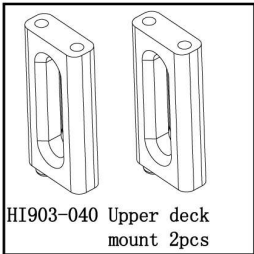

HI903-040 Upper deck mount 2pcs

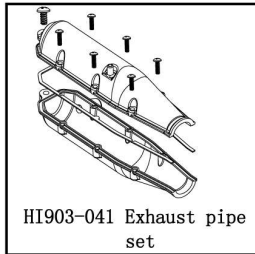

HI903-041 Exhaust pipe set

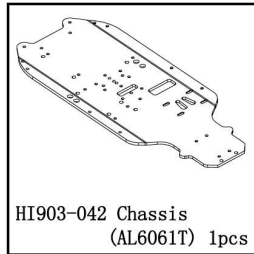

HI903-042 Chassis (AL6061T) 1pcs

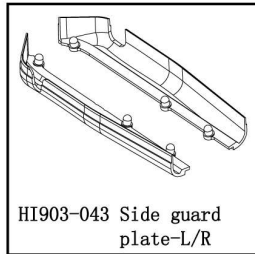

HI903-043 Side guard plate-L/R

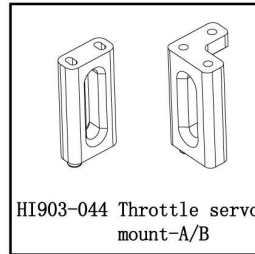

HI903-044 Throttle servo mount-A/B

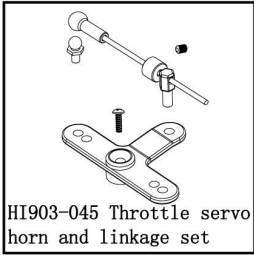

HI903-045 Throttle servo horn and linkage set

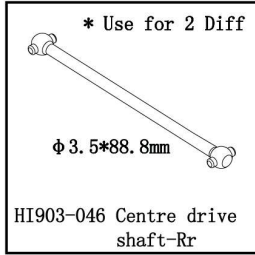

* Use for 2 Diff
HI903-046 Centre drive shaft-Rr
 $\phi 3.5 \times 88.8 \text{ mm}$



HI903-047 Centre gearbox unit

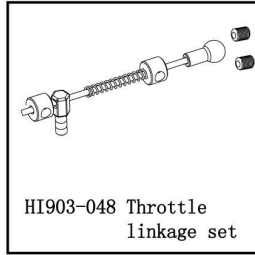

HI903-048 Throttle linkage set

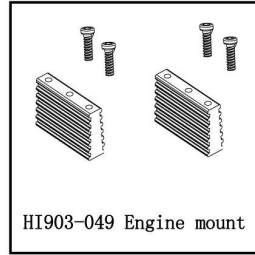

HI903-049 Engine mount

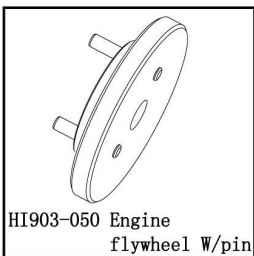

HI903-050 Engine flywheel W/pin

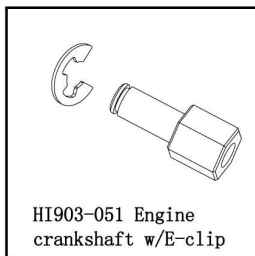

HI903-051 Engine crankshaft w/E-clip

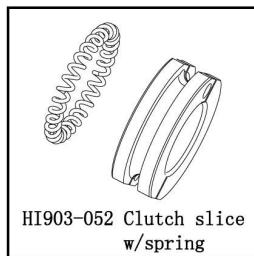

HI903-052 Clutch slice w/spring

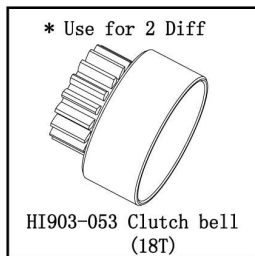

* Use for 2 Diff
HI903-053 Clutch bell (18T)

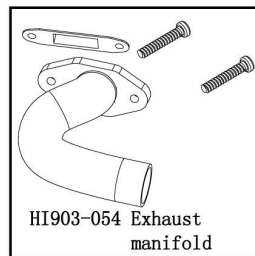

HI903-054 Exhaust manifold

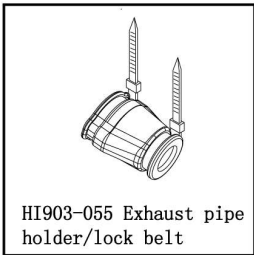

HI903-055 Exhaust pipe holder/lock belt

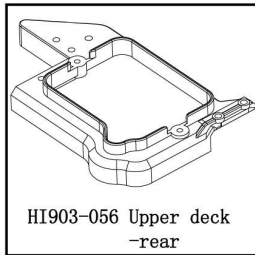

HI903-056 Upper deck -rear

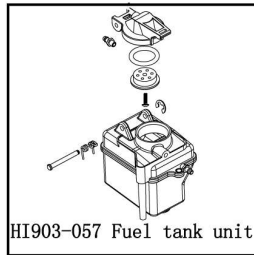

HI903-057 Fuel tank unit

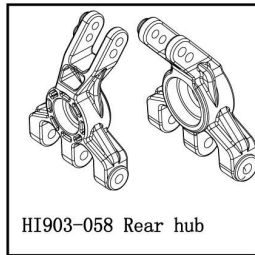

HI903-058 Rear hub

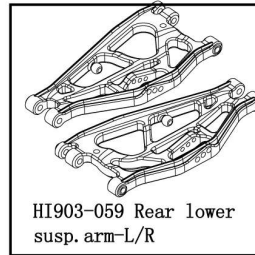

HI903-059 Rear lower susp. arm-L/R

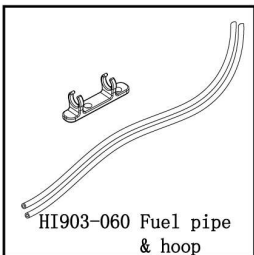

HI903-060 Fuel pipe & hoop

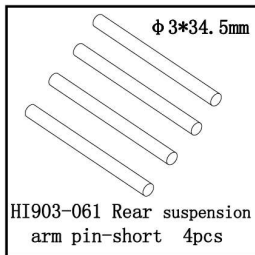

$\phi 3 \times 34.5 \text{ mm}$
HI903-061 Rear suspension arm pin-short 4pcs

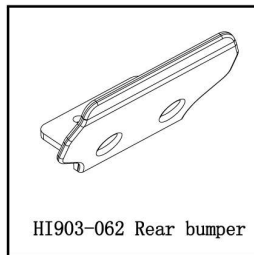

HI903-062 Rear bumper

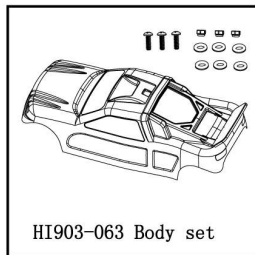

HI903-063 Body set

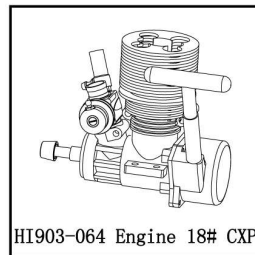

HI903-064 Engine 18# CXP

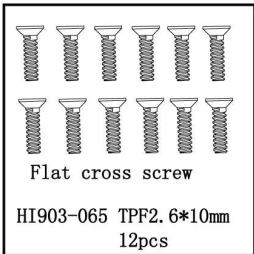

Flat cross screw
HI903-065 TPF2.6*10mm 12pcs

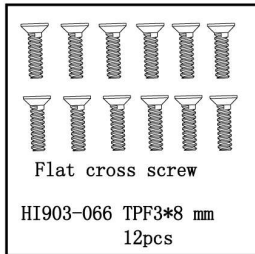

Flat cross screw
HI903-066 TPF3*8 mm 12pcs

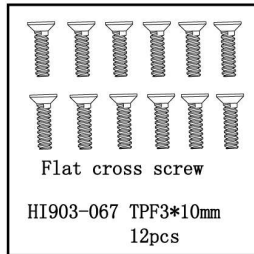

Flat cross screw
HI903-067 TPF3*10mm 12pcs

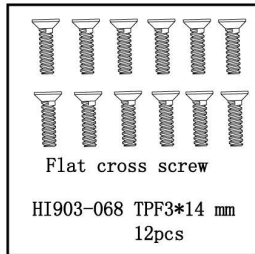

Flat cross screw
HI903-068 TPF3*14 mm 12pcs

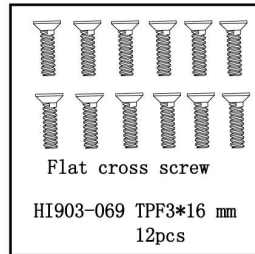

Flat cross screw
HI903-069 TPF3*16 mm 12pcs

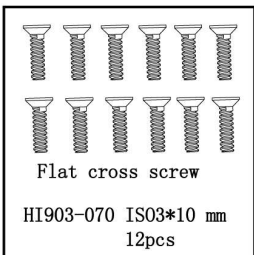

Flat cross screw
HI903-070 ISO3*10 mm 12pcs

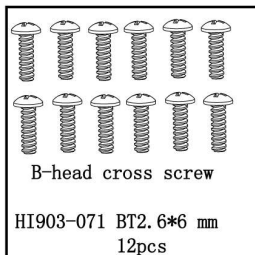

B-head cross screw
HI903-071 BT2.6*6 mm 12pcs

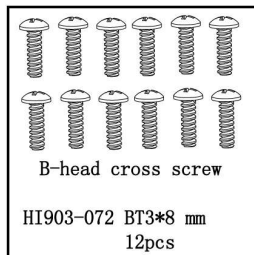

B-head cross screw
HI903-072 BT3*8 mm 12pcs

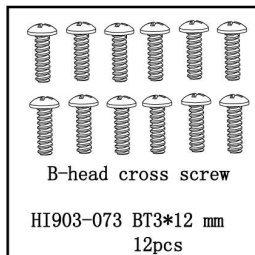

B-head cross screw
HI903-073 BT3*12 mm 12pcs

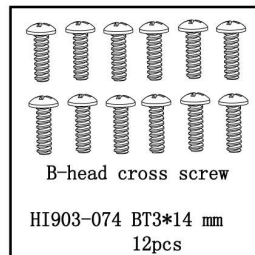

B-head cross screw
HI903-074 BT3*14 mm 12pcs

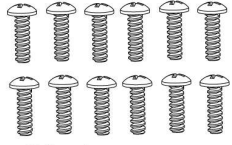

B-head cross screw

HI903-075 BT3*16 mm
12pcs

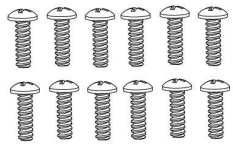

B-head cross screw

HI903-076 BT3*20 mm
12pcs

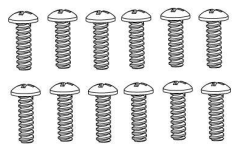

B-head cross screw

HI903-077 BT2.6*10 mm
12pcs



B-head cross screw

HI903-078 BT4*8 mm
12pcs

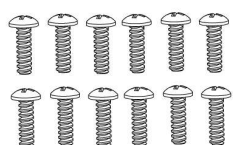

B-head cross screw

HI903-079 BM3*10 mm
12pcs

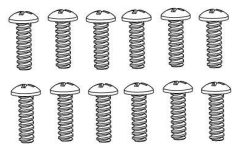

B-head cross screw

HI902-051 BT3*10 mm
12pcs

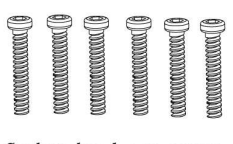

Socket head cap screw

HI903-080 M3*25 mm 6pcs

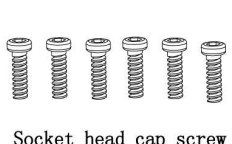

Socket head cap screw

HI903-081 M3*10 mm 6pcs

* For brake disc

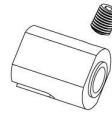

HI903-082 Diff. outdrive
C/set screw



HI903-083 Diff. outdrive
D/set screw

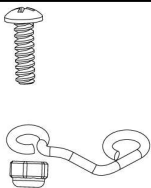

HI903-085 Exhaust
fixation set



HI903-086 Ball bearing
 $\phi 5 * \phi 10 * 4$ 2pcs



HI903-087 Ball bearing
 $\phi 12 * \phi 18 * 4$ 2pcs

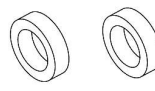

HI903-014 Ball bearing
 $\phi 6 * \phi 12 * 4$ 2pcs

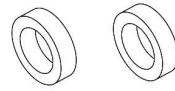

HI903-016 Ball bearing
 $\phi 10 * \phi 15 * 4$ 2pcs

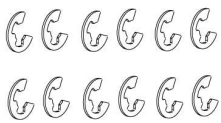

HI903-088 E-cilp
 $\phi 4 * 0.6$ mm 12pcs

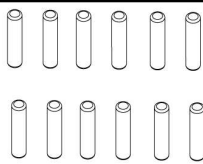

HI903-089 Pin $\phi 2 * 10$ mm
12pcs

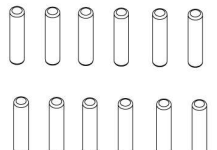

HI903-090 Pin $\phi 2 * 12.5$ mm
12pcs

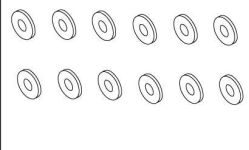

HI903-091 Washer
 $\phi 5.2 * \phi 10 * 0.2$ 12pcs

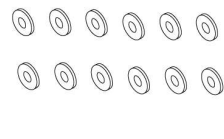

HI903-092 Washer
 $\phi 4.2 * \phi 8 * 0.2$ 12pcs

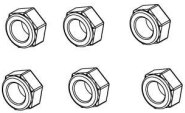

HI903-093 M4mm Nylon
lock-nut 6pcs

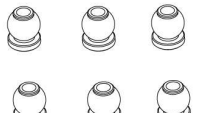

HI903-094 Double way
ball end 6pcs



HI903-095 Grub screw
M4*4mm 6pcs

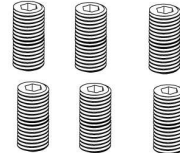

HI903-096 Grub screw
M4*8mm 6pcs

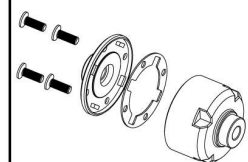

HI903-097 Diff. gearbox

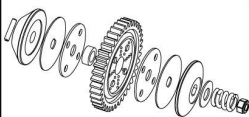

HI903-100 Spur gear/
spring/nylon-lock nut

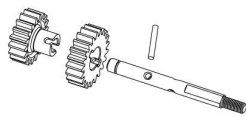

HI903-101 Pinion gear
18T/19T/pin

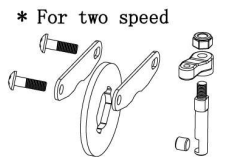

* For two speed

HI903-102 Brake set

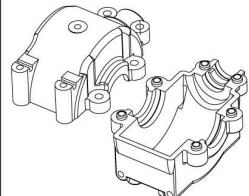

HI903-098 Diff. gearbox
bulkhead-upper/lower

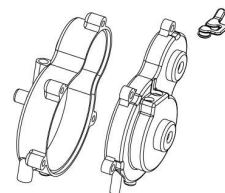

HI903-099 Gearbox case

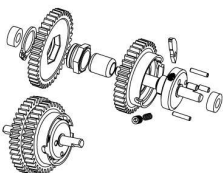

HI903-103 Gear-40T/37T

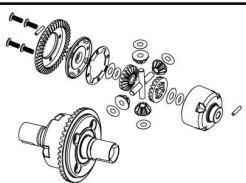

HI903-104 Diff. unit



HI903-105 Diff. unit

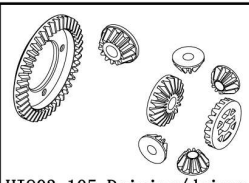

HI903-105 Driving/driven
gear
Diff. gear/bevel gears

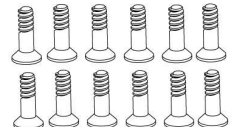

HI903-106 M3*9.5mm Screw
pin 12pcs

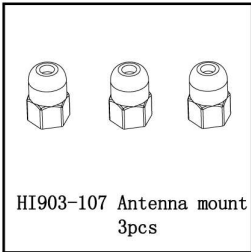

HI903-107 Antenna mount
3pcs

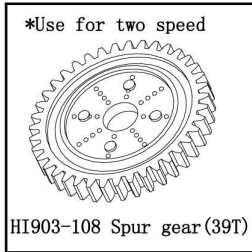

HI903-108 Spur gear (39T)

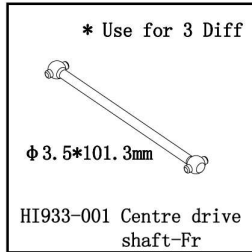

HI933-001 Centre drive
shaft-Fr

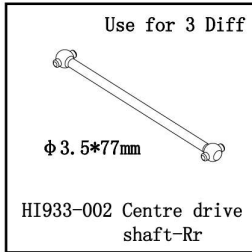

HI933-002 Centre drive
shaft-Rr

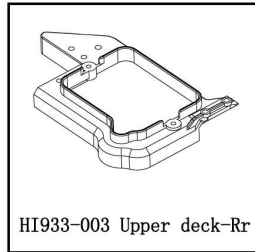

HI933-003 Upper deck-Rr

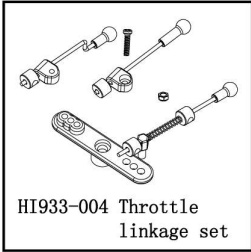

HI933-004 Throttle
linkage set

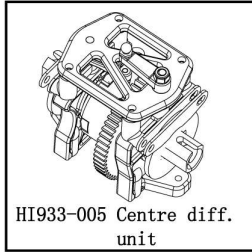

HI933-005 Centre diff.
unit

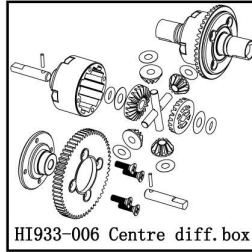

HI933-006 Centre diff. box

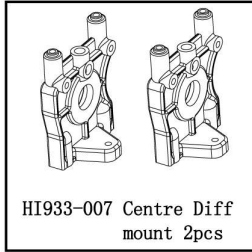

HI933-007 Centre Diff
mount 2pcs

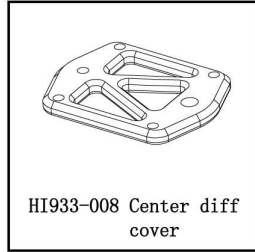

HI933-008 Center diff
cover

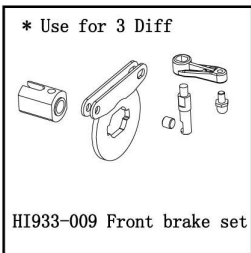

HI933-009 Front brake set

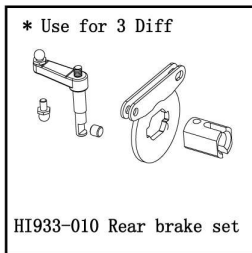

HI933-010 Rear brake set

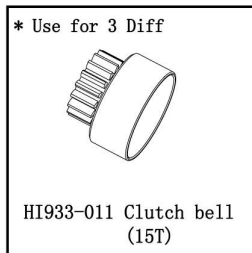

HI933-011 Clutch bell
(15T)

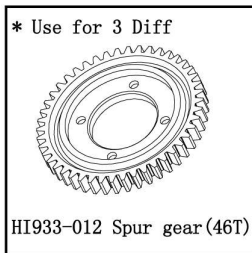

HI933-012 Spur gear (46T)

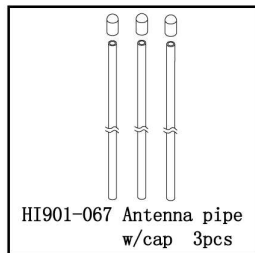

HI901-067 Antenna pipe
w/cap 3pcs



HI902-031 Air filter
w/insert

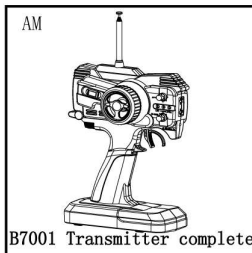

B7001 Transmitter complete

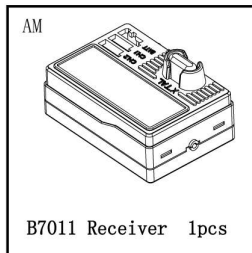

B7011 Receiver 1pcs

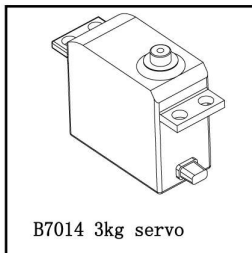

B7014 3kg servo

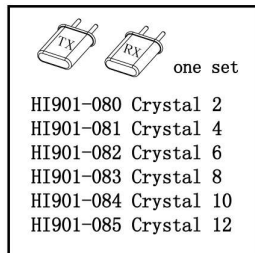

one set
HI901-080 Crystal 2
HI901-081 Crystal 4
HI901-082 Crystal 6
HI901-083 Crystal 8
HI901-084 Crystal 10
HI901-085 Crystal 12



MPO-01 Wheel Hex Set



MPO-02 C HCB C HUB Pin



MPO-03 Knuckle Arm Set



MPO-04 Rear Hub set



MPO-05 Shock stay mount



MPO-06 Front suspension
mount



MPO-07 Rear suspension
mount



MPO-08 Steel brake disk



MPO-09 Special brake
pads

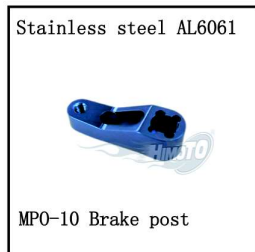

MPO-10 Brake post



MPO-11 Steering Rol



MPO-12 One pcs engine
mount



MPO-13 Sipper system
(hard anodized)



HI903-004 Shock absorber
unit (alum.)



MPO-15 Metal pipe